

The Courses up Yellow Britches Creek from the post to the Dogwood for Elliotts part - viz

S 3 E 30
S 4 E 16
S 72 W 24 70 in all.

Courses down Yellow Britches Creek from the ash to the Dogwood for Harts part - viz

N 70 E 45
N 32 E 15 1/2
N 70 E 12
S 73 E 49 1/2
122 in all

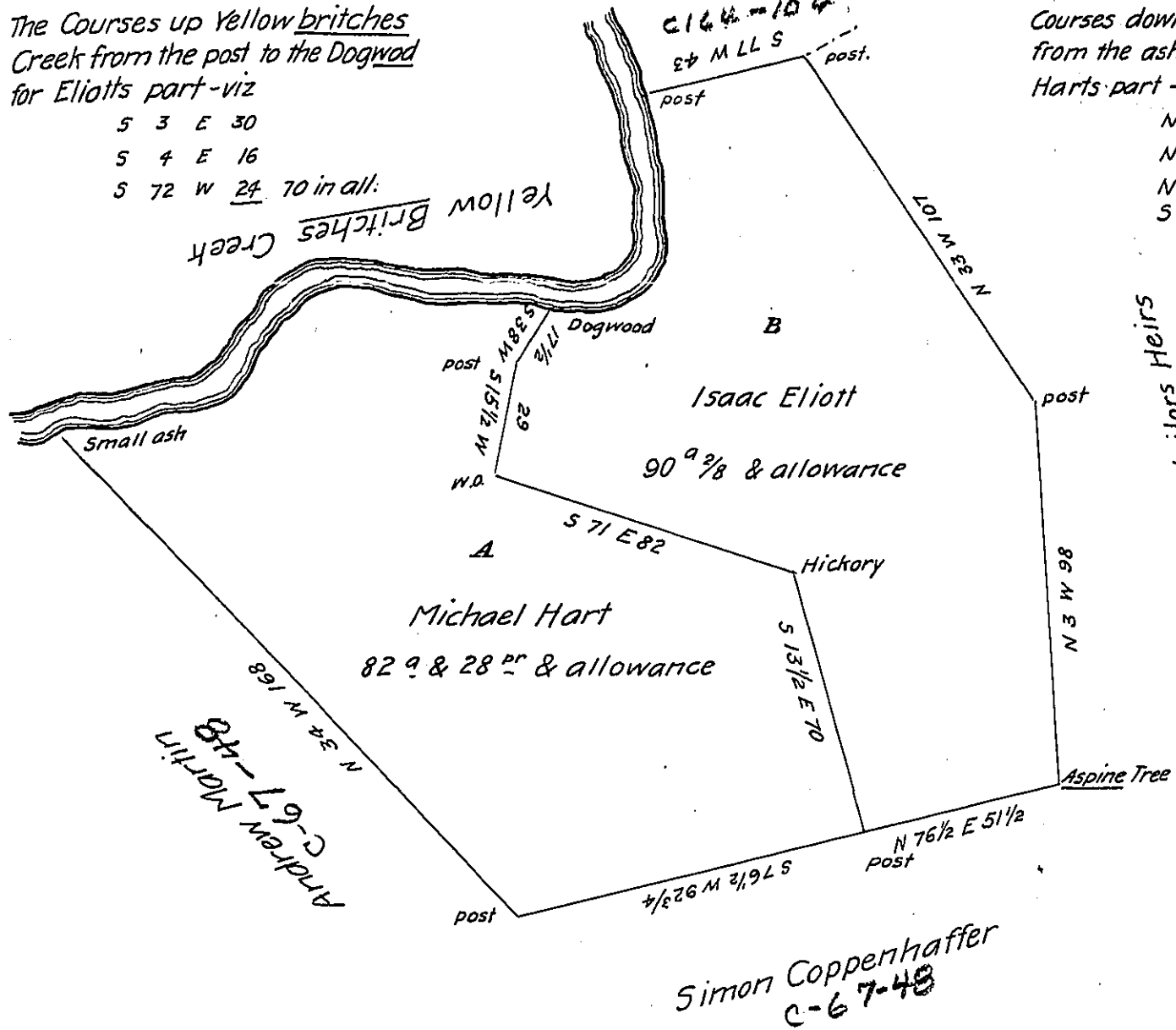

A draught of a Tract of Land situate in Newberry Township in the County of York Surveyed the 27th December 1792. In pursuance of a warrant to Samuel Elliot dated the 17th Decem^r. 1742. Contain- ing one hundred & seventy two acres and sixty eight perches and the usual allowance, also divided to the present owners as is above set forth

John Forsyth D.S.

To Daniel Brodhead Esq^r }
Surveyor General

IN TESTIMONY that the above is a copy of the original remaining on file in the Department of Internal Affairs of Pennsylvania, made conformably to an Act of Assembly approved the 16th day of February, 1833, I have hereunto set my Hand and caused the Seal of said Department to be affixed at Harrisburg, this thirtieth day of November 1904

George B. Brown
Secretary of Internal Affairs.